

\$129,900 - 573 461032 Hwy 13, Rural Wetaskiwin County

MLS® #E4439767

\$129,900

0 Bedroom, 0.00 Bathroom,
Rural on 0.45 Acres

Sunset Bay_CWET, Rural Wetaskiwin County,
AB

Immerse yourself in nature with wildlife at your door! Incredible .45 acre parcel of land to build your summer cottage getaway, a year round home, or park a trailer for the summer! Enjoy the peace and quiet away from the big cities, but it is only 90 minutes away from Edmonton, or 3 hours to Calgary.

Essential Information

MLS® #	E4439767
Price	\$129,900
Bathrooms	0.00
Acres	0.45
Type	Rural
Sub-Type	Vacant Lot/Land
Status	Active

Community Information

Address	573 461032 Hwy 13
Area	Rural Wetaskiwin County
Subdivision	Sunset Bay_CWET
City	Rural Wetaskiwin County
County	ALBERTA
Province	AB
Postal Code	T0C 0T0

Exterior

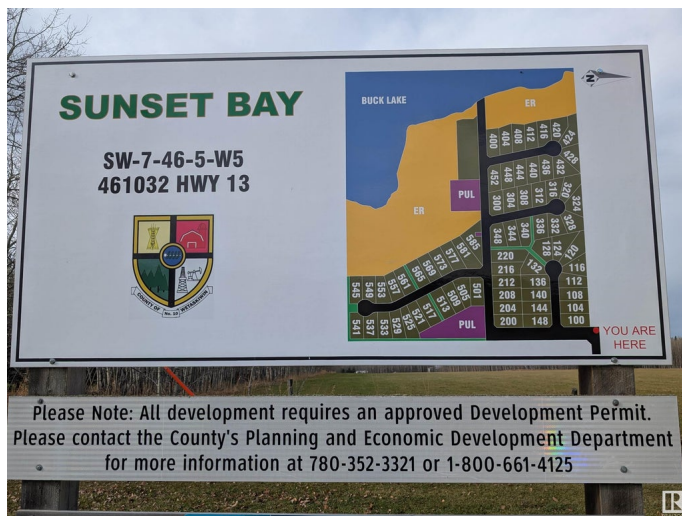

Exterior Features Beach Access, Boating, Environmental Reserve, Flat Site, Golf Nearby, Lake View, Park/Reserve, Picnic Area, Playground Nearby, Private Setting

Additional Information

Date Listed May 30th, 2025
Days on Market 17
Zoning Zone 96

DATA IS DEEMED RELIABLE BUT IS NOT GUARANTEED ACCURATE BY THE REALTORS® ASSOCIATION OF EDMONTON. COPYRIGHT 2025 BY THE REALTORS® ASSOCIATION OF EDMONTON. ALL RIGHTS RESERVED.Trademarks are owned or controlled by the Canadian Real Estate Association (CREA) and identify real estate professionals who are members of CREA (REALTOR®, REALTORS®) and/or the quality of services they provide (MLS®, Multiple Listing Service®)
Listing information last updated on June 16th, 2025 at 6:17pm MDT