

\$129,900 - 573 461032 Hwy 13, Rural Wetaskiwin County

MLS® #E4439767

\$129,900

0 Bedroom, 0.00 Bathroom,
Rural on 0.45 Acres

Sunset Bay_CWET, Rural Wetaskiwin County,
AB

Immerse yourself in nature with wildlife at your door! Incredible .45 acre parcel of land to build your summer cottage getaway, a year round home, or park a trailer for the summer! Enjoy the peace and quiet away from the big cities, but it is only 90 minutes away from Edmonton, or 3 hours to Calgary.

Essential Information

| | |
|-----------|-----------------|
| MLS® # | E4439767 |
| Price | \$129,900 |
| Bathrooms | 0.00 |
| Acres | 0.45 |
| Type | Rural |
| Sub-Type | Vacant Lot/Land |
| Status | Active |

Community Information

| | |
|-------------|-------------------------|
| Address | 573 461032 Hwy 13 |
| Area | Rural Wetaskiwin County |
| Subdivision | Sunset Bay_CWET |
| City | Rural Wetaskiwin County |
| County | ALBERTA |
| Province | AB |
| Postal Code | T0C 0T0 |

Exterior

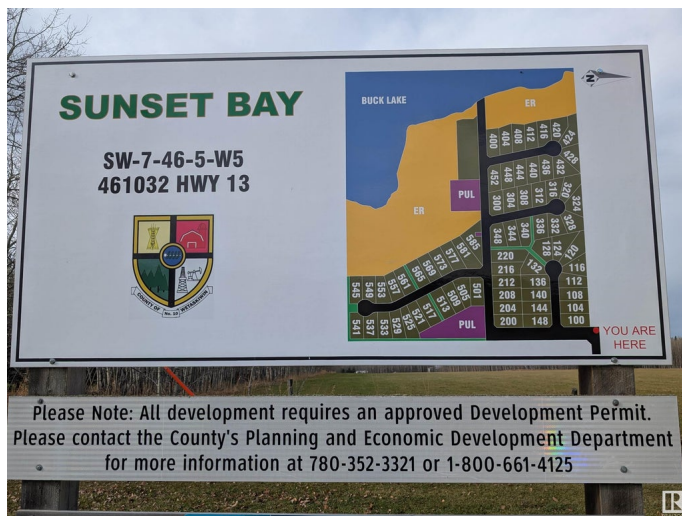

Exterior Features Beach Access, Boating, Environmental Reserve, Flat Site, Golf Nearby, Lake View, Park/Reserve, Picnic Area, Playground Nearby, Private Setting

Additional Information

Date Listed May 30th, 2025
Days on Market 74
Zoning Zone 96

DATA IS DEEMED RELIABLE BUT IS NOT GUARANTEED ACCURATE BY THE REALTORS® ASSOCIATION OF EDMONTON. COPYRIGHT 2025 BY THE REALTORS® ASSOCIATION OF EDMONTON. ALL RIGHTS RESERVED.Trademarks are owned or controlled by the Canadian Real Estate Association (CREA) and identify real estate professionals who are members of CREA (REALTOR®, REALTORS®) and/or the quality of services they provide (MLS®, Multiple Listing Service®)
Listing information last updated on August 12th, 2025 at 5:47pm MDT